

## DATASHEET

---

# Thermowell



**SMTECH ENGINEERING SOLUTION INDIA PRIVATE LIMITED**

Nakshatra Apartment, Gawade Business Centre,

Wing A-01, First Floor, Survey No. 50/3B & CTS No. 4349,

Akurdi, Pune-411035, Mob NO:7028526873

Email: [sales@smtechindia.co.in](mailto:sales@smtechindia.co.in)



**SMTECH**  
MADE FOR PRECISION



## Flushing Ring



### Product overview

---

Thermowells for temperature instruments are recommended for all process systems where pressure, velocity or viscous, abrasive and corrosive materials are present individually or in combination. A properly selected thermowell will protect the temperature instrument from possible damage resulting from these process variables. Furthermore, a thermowell permits removal of the temperature instrument for replacement, repair or testing without effecting the process media or the system.

### Applications

---

- Chemical, process, apparatus and plant engineering; petrochemical; on offshore
- High chemical loads
- High process loads

### Standard Features

---

- Type: Drilled Barstock, Fabricated
- Construction: Tapered, Straight, Stepped, Helical
- Thermowell Material: SS-304/304L, SS-316/316L
- Process Connection: Screwed, Flanged

### Optional Features

---

- Material: SS-321, Alloy 20, Hastelloy C276, Monel 400, Inconel 600, Titanium (More material on request)
- Special requirements for Stellite overlay for corrosion resistance, PTFE and other protective coating is also available.



## Flushing Ring



### Technical Specifications

#### Threaded Thermowell

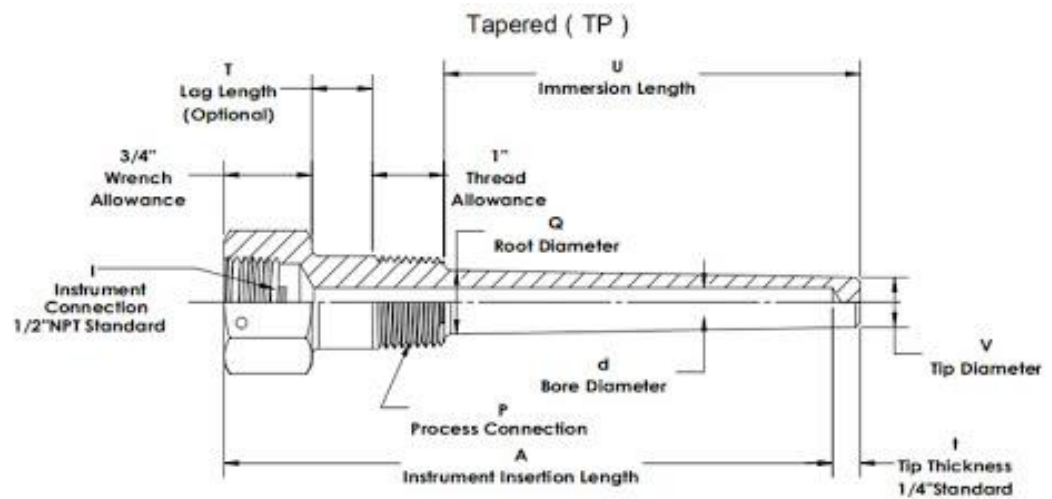

#### Flanged Thermowell

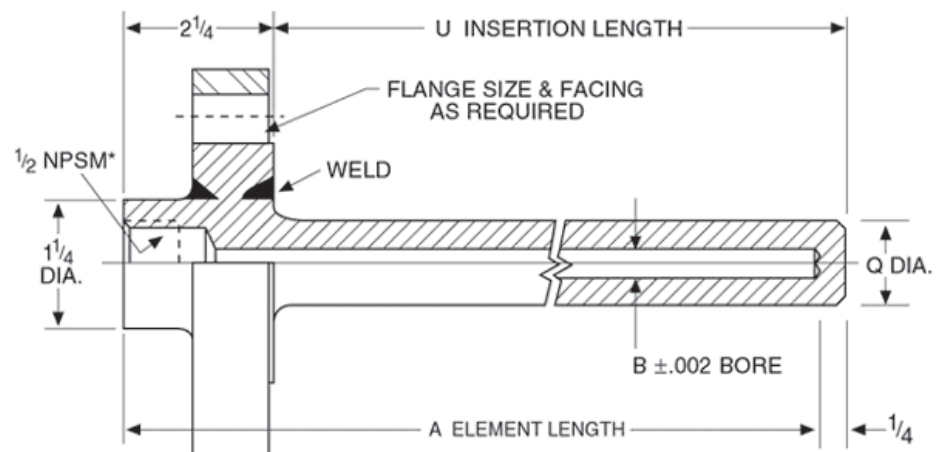

#### Note:

Other process connections and materials on request

Sealing gasket are not part of standard supply and should be made of a material appropriate for process medium.

## Flushing Ring

### Documentation

---

Following documents shall be provided as a standard part of supply,

- 1) Dimensional test report.
- 2) Material certificate 3.1 acc. to EN-10204 for all wetted parts

For inquiries contact us at:

### SMTECH ENGINEERING SOLUTION INDIA

#### PRIVATE LIMITED

Nakshatra Apartment, Gawade Business Centre,  
Wing A-01, First Floor, Survey No. 50/3B & CTS No. 4349,  
Akurdi, Pune-411035, Mob NO:7028526873  
Email: [sales@smtechindia.co.in](mailto:sales@smtechindia.co.in)

